

Metal diaphragm valve KMA 495

Pneumatically Operated Valve DN 15 - 100 mm (3/4" - 4")

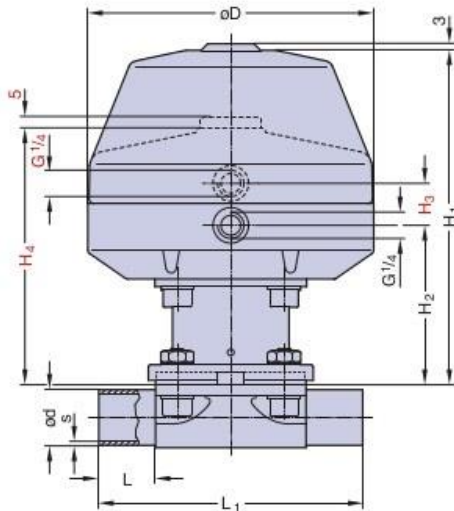

Cf. 1



Features

- Plastic diaphragm actuator with stainless steel distance piece
- Control air connection 90° to flow direction
- Flexible diaphragm suspension
- Encapsulated diaphragm
- CDSA sealing concept, see page 30

Optional

- Available with a wide range of control equipment and accessories see page 100 to 106, also for retrofitting

Technical Data

Control function (Cf.): Pneumatically operated
Fail safe close (NC): Cf. 1
Fail safe open (NO): Cf. 2
Double acting (DA): Cf. 3

Direction

Control connection: At Cf. 1, 2 & 3, 90° to flow direction, standard
Max. working pressure: Unidirectional (delta p = 100%)

Diaphragm	DN 15-50 (2")	DN 65-80 (2,5"-3")	DN 100 (4")
EPDM	10 bar (145 psi)	7 bar (101 psi)	6 bar (87 psi)
PTFE	8 bar (116 psi)	6 bar (87 psi)	5 bar (72 psi)

Higher working pressure may be achieved with different actuator. Please consult a SED factory representative for working pressure above the indicated maximum.

Max. working temperature: 160°C (320°F) dependent on application

Control pressure:
Cf. 1 DN 15-50 4,5 - 6 bar (65-87 psi)
Cf. 1 DN 65-80 4,5 - 7 bar (65-101 psi)
Cf. 1 DN 100 5,5 - 7 bar (80-101 psi)
Cf. 2 & 3 DN 15-80 4 - 5,5 bar (60-80 psi)
Cf. 2 & 3 DN 100 5 - 6,5 bar (72-93 psi)

Diaphragm material: EPDM or PTFE
Valve body material: Forged 1.4435/ 316 L ASME/BPE
Investment cast 1.4435/ 316 L
Other alloys

End connection: Butt weld ends
Clamps and flanges
Special ends

Actuators suitable for: Two-Way bodies
Welded configurations
T-bodies
Multiport bodies
Tank bottom bodies

Flow rate: Kv in m³/h (Cv in GPM)
Diaphragm size: MA see table below

DN (mm)	Dimensions (mm)							D
	MA	L	L ₁	H ₁	H ₂	H ₃	H ₄	
15-25	25	25	120	148	71	31	120	130
32-40	40	25	153	194	95	31	144	161
50	50	30	173	233	109	31	177	217
65	80	30	216	314	166	41	275	265
80	80	30	254	314	166	41	275	265
100	100	30	305	314	166	41	284	265

Note: H3 and H4 only for valves with Cf. 2 and Cf. 3
H1 only for valve with Cf. 1